

Butcher Street, Leeds, LS11

Approximate Area = 393 sq ft / 36.5 sq m
For identification only - Not to scale

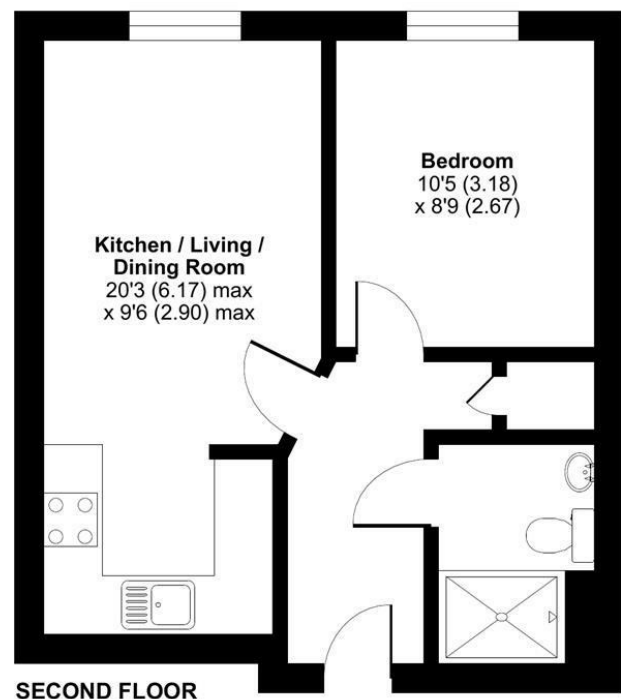

Certified Property Measurer RICS Floor plan produced in accordance with RICS Property Measurement Standards incorporating International Property Measurement Standards (IPMS2 Residential). © nichicom 2022. Produced for Vision Properties. REF: SS1613.

PROPERTY ADDRESS
24 Butcher Street
Butcher Street
Leeds
LS11 5WF

Energy Efficiency Rating		
	Current	Potential
Very energy efficient - lower running costs		
(92 plus) A		
(81-91) B		
(69-80) C		
(55-68) D		
(39-54) E		
(21-38) F		
(1-20) G		
Not energy efficient - higher running costs		
England & Wales	EU Directive 2002/91/EC	

Butcher Street, LS11



Call Us
01132440251

Email Us
leeds@vision-properties.co.uk

vision

We look at
estate agency
differently.

vision

- Total cost of first month: £1,669.23 (rent & deposit)
- Excellent location
- Close to Leeds train station
- Furnished
- Holbeck Urban Village

Vision Properties are delighted to offer this modern one bedroom apartment in this popular city centre location.

The property benefits from contemporary fixtures and fittings and boasts double height windows providing lots of natural light. It briefly comprises of a spacious hallway leading to an open plan kitchen/living area, a good-sized double bedroom, well-proportioned shower room and large storage cupboard.

The apartment is in the sought after Holbeck Urban Village in Leeds city centre, close to the south entrance of Leeds train station. Situated just a stone's throw away from fantastic pubs such as the Midnight Bell, Cross Keys and Northern Monk Refectory and the eateries that Granary Wharf has to offer.

Available now pending acceptable referencing.

Rent: £775 per calendar month
 Deposit: £894.23
 Holding deposit: £178.84

Please note the apartment does not come with parking.



1 bedroom
 Apartment
 £775 PCM



The property benefits from contemporary fixtures and fittings and boasts double height windows providing lots of natural light. It briefly comprises of a spacious hallway leading to an open plan kitchen/living area, a good-sized double bedroom, well-proportioned shower room and large storage cupboard.

The apartment is in the sought after Holbeck Urban Village in Leeds city centre, close to the south entrance of Leeds train station. Situated just a stone's throw away from fantastic pubs such as the Midnight Bell, Cross Keys and Northern Monk Refectory and the eateries that Granary Wharf has to offer.

Available now pending acceptable referencing.

Rent: £775 per calendar month
 Deposit: £894.23
 Holding deposit: £178.84

Please note the apartment does not come with parking.